

# TrueCut

EASY • SAFE • ACCURATE

The Grace Company  
Fine Quilting Frames

*My Comfort Cutter*



Works with: Truecut Ruler  
(sold separately)

**Accurate:** The Ruler Guide interlocks with the edge of the TrueCut Ruler, letting you make straight, precise cuts every time!

**Easy:** As you move the cutter effortlessly along the ruler's track, the guide keeps your cutter from veering away.

**Safe:** The Ruler Guide keeps your fingers safer by preventing accidental slips.

## Step 1- Replacing Blade:

**1-1:** To change the blade, unscrew the back knob and pull out the blade bolt.

**1-2:** Carefully pull out the blade bolt and remove the 45mm blade.

**1-3:** Replace 45mm blade with a new or sharpened blade.

**1-4:** Insert blade bolt with the ruler guide and blade back through cutter, as shown in Fig. 1-1.

**Note:** If a using Zig Zag Blade, remove zig zag blade spacer from the back of the cutter and place it between the safety guard and blade.

Fig. 1-1

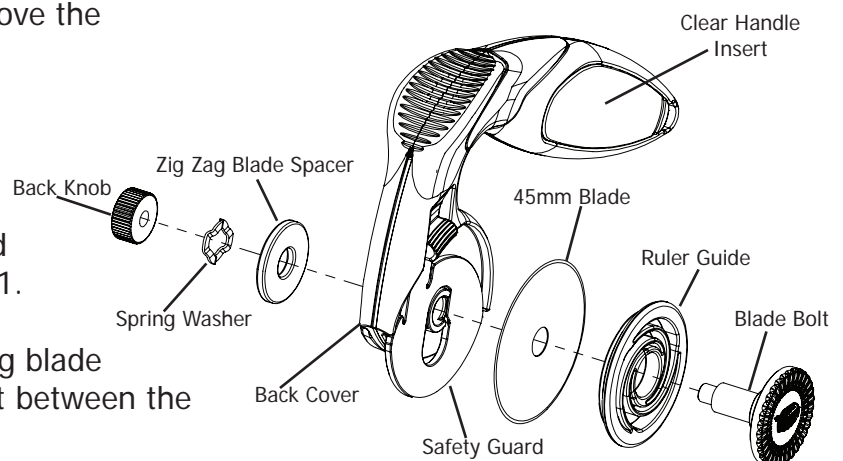

## Additional Steps

### Step 2- Changing the Cutter Setup for Right/Left Handed

Fig. 2-1

**2-1:** To setup the cutter for left or right handed Remove all components, as shown in Fig 1-1.

**2-2:** Replace the Safety guard on the side you will be installing the blade on (for left handed users install safety guard on the right side, for right handed user install the safety guard on the left side). Insert safety guard into cutter by placing it in at an angle and then sliding it down to lock in place.

**2-3:** Replace back cover, on the opposite side of safety guard, by inserting the back cover straight on and sliding up, as shown in Fig. 2-1.

**2-4:** Replace all other components, as shown in Fig. 1-1

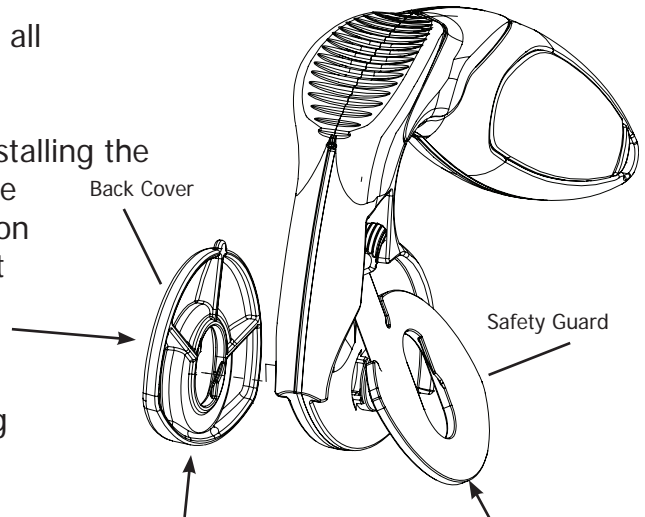
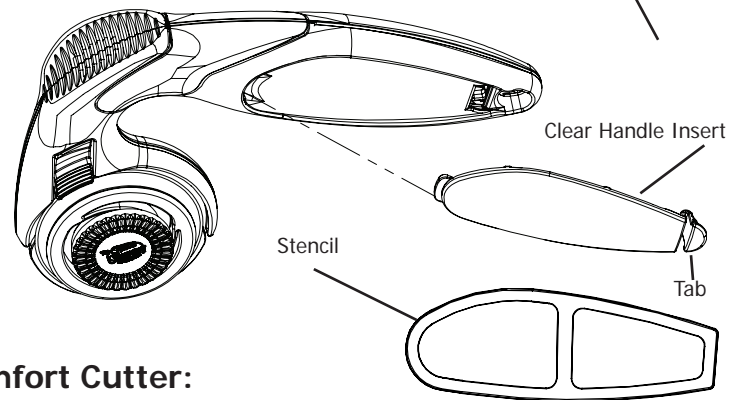

Fig. 3-1



### Step 3- Making My Comfort Cutter your Comfort Cutter:

**3-1:** Remove Clear Handle Insert by pushing and lifting on the tab.

**3-2:** Remove the previous paper insert from the handle.

**3-2:** Use stencil to trace image/fabric of choice, then cut out and insert into My Comfort Cutter.

**Note:** the stencil can be flipped over to outline either left or right side paper inserts

**3-3:** Replace Clear Handle Insert by placing, as shown in Fig. 3-1, and pressing on the tab until secured into place.

My Comfort Cutter Is unique in that it can be held in many different ways. It's ergonomic handle makes cutting easier than ever. To the right are some options of how it can be held when cutting. Try some of them out and use it however feels most comfortable to you.



Patent(s) Pending  
1-800-264-0644  
www.graceframe.com



TrueCut and The Grace Company logo  
are trademarks of TrueCut  
and The Grace Company.  
©2010 TrueCut.  
MADE IN CHINA

 **Caution:** contains sharp blade